

FRONT ELEVATION

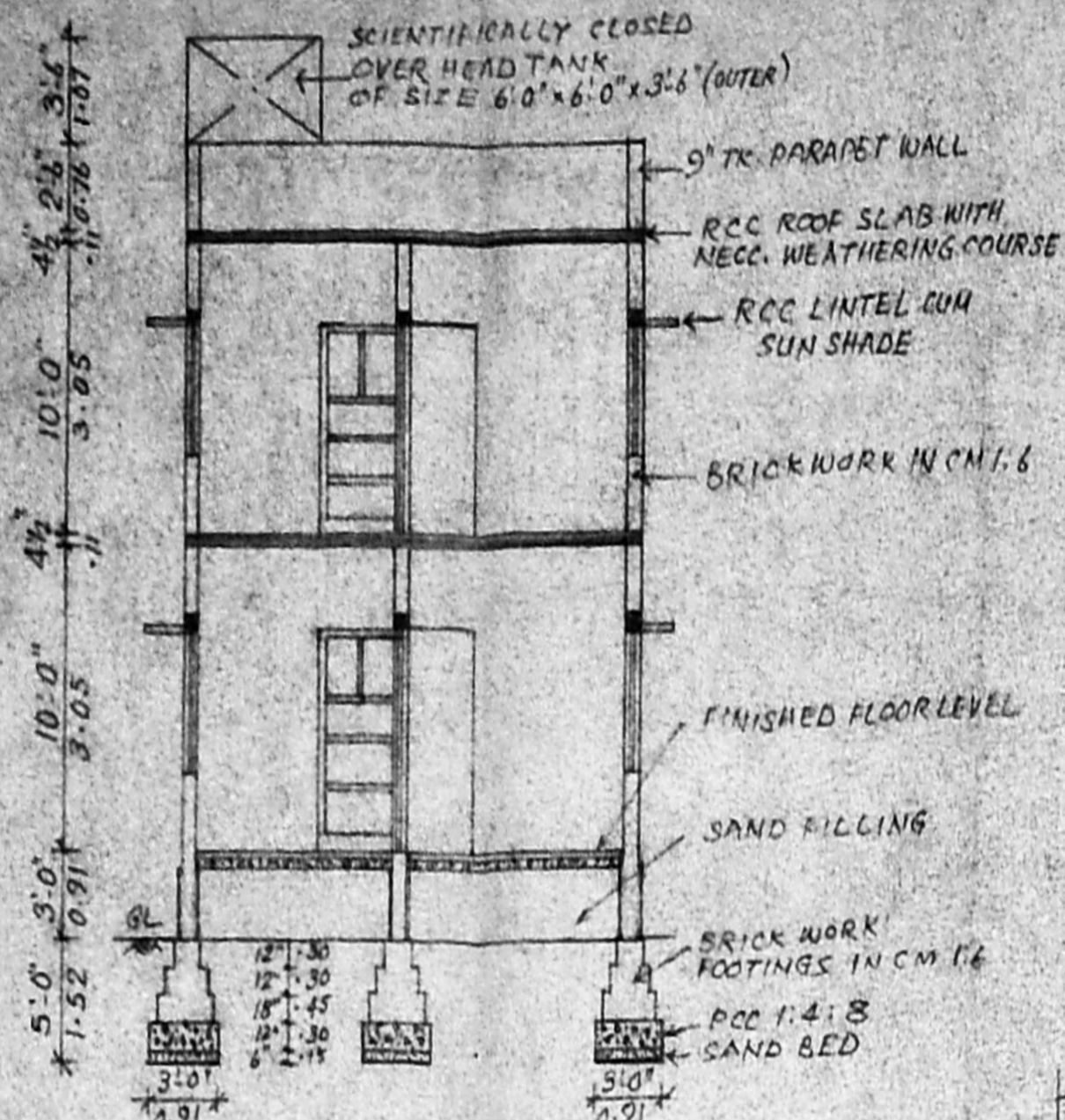

SECTION ON 'AB'

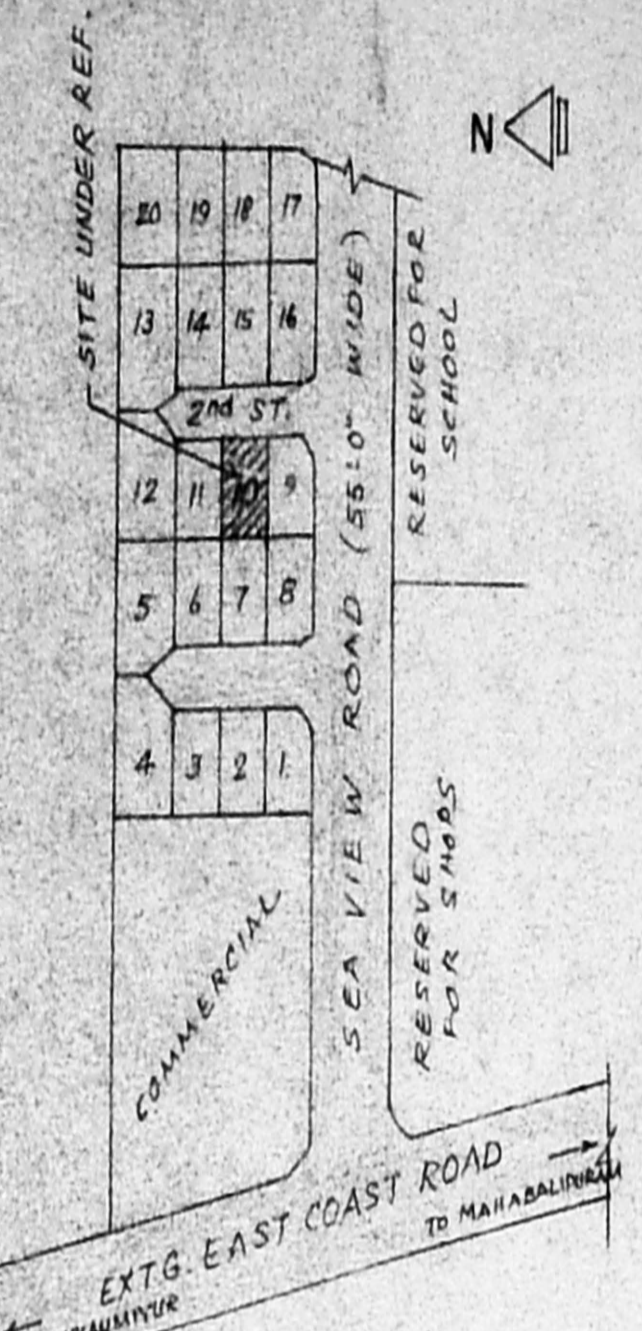

KEY PLAN  
(NOT TO SCALE)

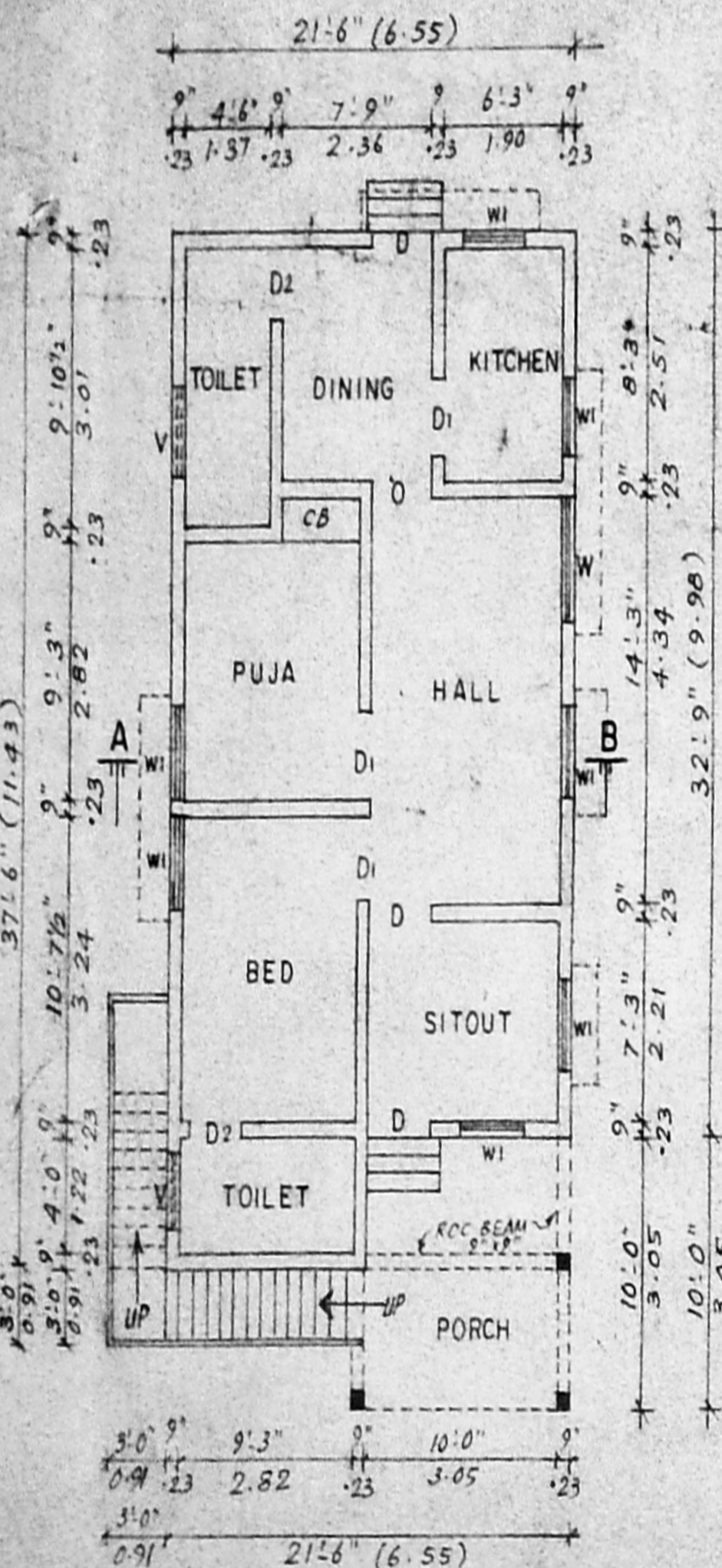

EXTG. GR. FLOOR PLAN

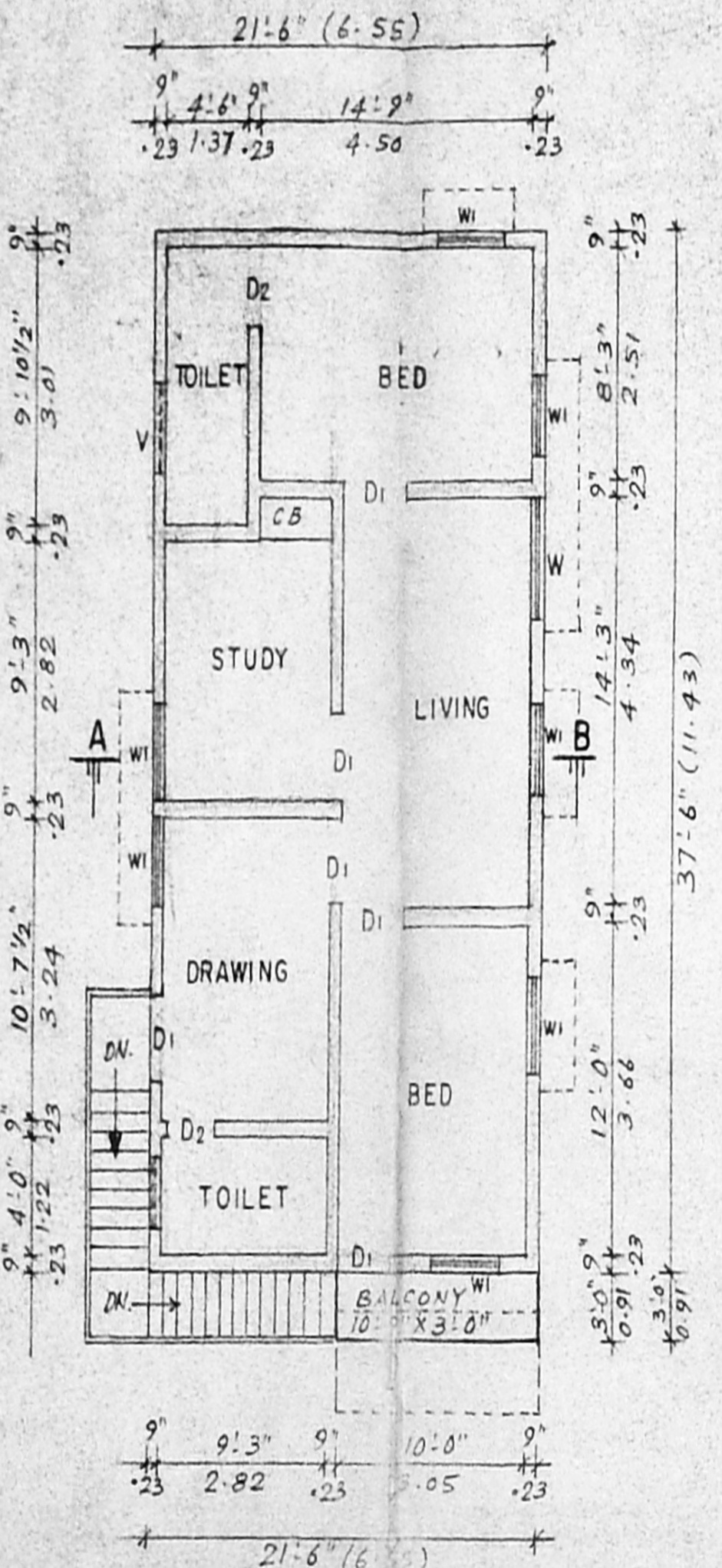

PRO. FIRST FLOOR PLAN

Planning Permit No. 1/20508/394/94

**APPROVED**

SUBJECT TO THE CONDITIONS IN THIS OFFICE LETTER.

No. 12/1567/96. DATED 28/8/98

FOR MEMBER SECRETARY  
MADRAS METROPOLITAN  
DEVELOPMENT AUTHORITY  
MADRAS - 600 008.

38.2% (11.58)

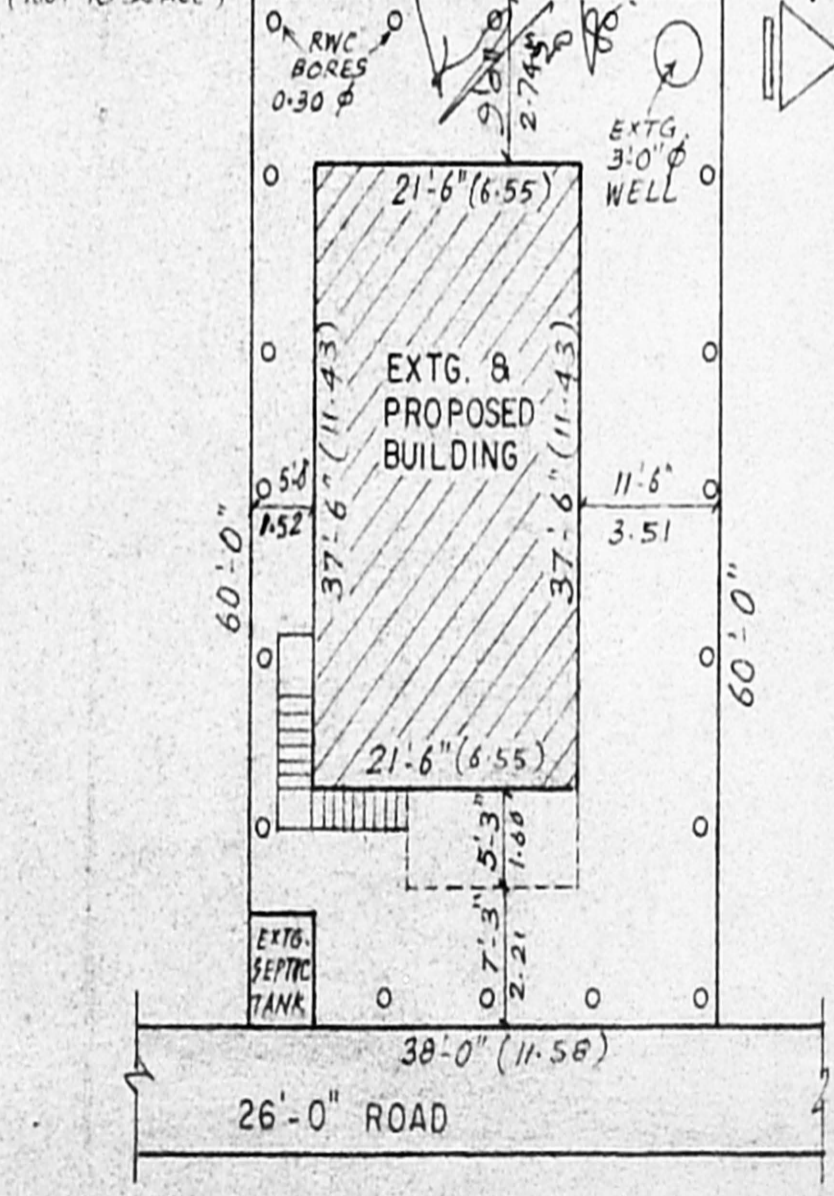

SITE PLAN  
(Scale: 1:200)

PREVIOUS PLAN SANCTIONED FOR GR. FLOOR VIDE LR.No. D.DIS. 3044/82 DATED 29.7.82. ST. THOMAS MOUNT PANCHAYAT UNION, CHITLAPAKKAM.

REVISED PLAN SHOWING THE EXISTING GROUND FLOOR AND PROPOSED ADDITIONAL CONSTRUCTION OF FIRST FLOOR IN PLOT No.10, S.No. 1pt. & 80pt. OF 'PALKALAI NAGAR', PALAVAKKAM VILLAGE, SAIDAPET TALUK, CHENGAI M.G.R. DISTRICT.

SCALE - 1" = 8'-0" (1:100)

**SPECIFICATIONS**

FOUNDATION IN BRICK WORK FOOTINGS IN CM 1:6 MIX OVER PCC 1:4:8. MASONRY USING STOCK BRICKS IN CM 1:6. FLOORING IN CC 1:5:10 AND TOP FINISHED WITH MOSAIC TILES. PLASTERING IN CM 1:5 MIX FOR EXPOSED WALLS AND IN CM 1:3 MIX FOR CEILING. ALL RCC WORKS IN CC 1:2:4 USING NECC STEEL. WOOD WORK USING BEST SEASONED TEAK/COUNTRY WOOD. FINISHING WITH COLOUR CEMENT PAINT TO WALLS AND ENAMEL PAINT TO WOODWORK.

**JOINARY DETAILS**

- D - T.W. DOOR : 3'-3" x 7'-0" (1.00 x 2.15)
- D1 - C.W. DOOR : 3'-0" x 7'-0" (0.91 x 2.15)
- D2 - C.W. DOOR : 2'-6" x 7'-0" (0.76 x 2.15)
- W - " WINDOW : 4'-6" x 5'-0" (1.37 x 1.52)
- W1 - " " : 3'-0" x 5'-0" (0.91 x 1.52)
- V - " VENTILATOR : 3'-0" x 1'-6" (0.91 x 0.45)

**COLOUR INDEX**

- EXISTING
- PROPOSED
- TO BE REGULARISED
- SITE BOUNDARY

**AREA DETAILS**

PLOT AREA : 2280 SFT. 211.80 SMT.  
 EXTG. G.F (INCL. PORCH) : 866.50 " 80.50 "  
 PRO. F.F (INCL. BALCONY) : 838.50 " 77.90 "  
 TOTAL BUILT-UP : 1705.00 SFT. 158.40 SMT.  
 PLOT COVERAGE : 38%  
 FLOOR SPACE INDEX (FSI) : 0.75 TIMES.

*SKPOOF*  
OWNER'S SIGNATURE

R. Mohan Red, D.C.E.,  
LICENSED SURVEYOR  
Corporation of Madras  
REG. No. 14  
AMBATTUR TOWNSHIP  
ALANDUR MUNICIPALITY  
Consulting Engineer  
Office: 10, Madley Road,  
NAGAR, MADRAS - 600 011  
LICENCED SURVEYOR

